

170BCxM, 170BCxMF, 170BTxM SingleTouch Computer Data Sheet

PALAS
ISO 9001:2008 Certified

| | |
|---------------------|--|
| Size | 43cm (17") |
| Models | 170BCxM, 170BCxMF, 170BTxM |
| Touch Screen | |
| Touch Points | Single Touch |
| Input Method | Finger, or 3M Smart pen. |
| Touch Screen | 3M MicroTouch™ Surface Capacitive |
| Touch response time | less than 5.4 ms |
| Accuracy | > 99% of True Position |
| Light Transmission | greater than 91% |
| Touch resolution | 16K x 16K with EXII controllers |
| Surface Finish | Anti-reflective, easy-glide, ClearTek Hard coat |
| Surface scratch | Hardness MoHS 7 or higher to induce a functions failure |
| Surface Obstruction | Not affected by surface contaminants like dust, grease, moisture, liquids, paan stains |
| Chemicals | Resistant to corrosives, as per ASTM D1308-02 & ASTM F-1598-95 |
| Optional Protection | Front face sealable to Nema 4X / IP65 Front protected from sprays of water |

| | |
|---------------------------------|----------------|
| Display | |
| Format | 4:3 |
| Display Area (mm) | 338 x 270 |
| Pixel Pitch | 0.264 |
| Brightness (cd/m ²) | 250 |
| Resolution | 1280 x 1024 |
| Viewing Angle | H >140, V >140 |

| | |
|------------------|--|
| Processor | |
| Operating System | Standard Win 7 HB Optional : Win 8 / Win 7 Prof |
| Processor | Standard Atom ; Optional Intel i3 i5 / i7 |
| RAM | 4 GB |
| Hard Disk | 60 GB SSD |
| I/O | Standard : 2 x USB, 1xLAN Optional :WiFi, Serial Port, 6 USB, MSR, BarcodeScanner |

| | |
|-------------------|--------------------|
| Others | |
| Operating Temp | 0 - 45° C |
| Relative Humidity | 85% non-condensing |
| Connectors-Power | 220VAC |
| Power (W) max | 100 |
| Touch PC made in | India |

| | |
|--------------------|--------------------------------|
| Model Types | |
| xxxBCxM | Standard model (metal bezel) |
| xxxBCxMF | Flange model (for panel mount) |
| xxxBCxMT | High temperature rating |
| xxxBCxM-U | Ultra high resolution |
| xxxBTxM | Toughened glass (UL 1950) |

PALAS Single-Touch Computers (BCxx series)
Palas Touch computers, based on 3M Capacitive touch technology and electronics, offer fast, accurate touch with a response time of just 5 ms, the world's fastest.

Touch operation unaffected by liquids, dust, dirt, grease

Anti-reflective finish for use in high brightness areas, smooth easy glide surface coating, metal body for hot & harsh environments. All sizes from 15" to 55"

Made in India

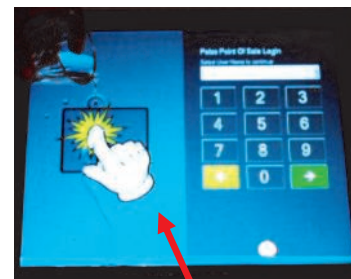

Optional - Water / liquid spills do not affect operation.



Palas manufactures in India:

- Touchscreen monitors, Touch All-in-ones, 10" to 55"
- Industrial Touch Panel PCs, Rugged touch systems
- POS systems
- Smart Card Readers for ATMs, Kiosks, Vending
- Interactive Digital Signage Systems for Malls, Factories, Buildings

Palas is the Master Distributor in South Asia for:

- Touch Screens from 3M Touch Systems, USA
- Motorized & Dip Smart Card Readers from Sankyo, Japan

Palas is an IIT / IIM alumnus enterprise

 /PalasSoftware



 /user/palassoftware1



PALAS Software Pvt Ltd.

S-74 Okhla Industrial Area Phase 2, New Delhi 110020 INDIA

Tel: +91-11-41708030 Fax: +91-11-41708037 Email: sales@palas-india.com Web: http://www.palas-india.com
Bangalore 80950-48512, Chennai 93600-86824, Hyderabad 93936-86824, Kolkata 93309-86824, Mumbai 98205-03354

Regd Off: B - 39 Kailash Colony, New Delhi 110048 ; Plant 2: : Roorkee, Uttarakhand, India